

SOLD



1 Mitchell St, Axedale



Fabulous lifestyle property or development property (STCA) in picturesque Axedale

- Outstanding picturesque lifestyle property of 6.6 acres in beautiful Axedale (20 minutes to Bendigo)
- Fabulous opportunity to secure this 6.6 acres that can be sub-divided (STCA) with various options available to the astute investor
- Magnificent home (Built 2003) offering 4 bedrooms and three living areas
- Master bedroom with walk in robe and ensuite, 2nd bedroom with its own ensuite
- Double garage and workshop plus two additional sheds for vehicles etc
- Axedale is a lovely township only 20 minutes from Bendigo/Strathdale, it is becoming increasingly more a highly sought after township where land values continue to escalate
- Split system, solid fuel heater, double glazed windows, solar hot water, 30,000 litres rainwater storage tanks etc
- A very nice rural outlook and the home is close to all

4 Beds 3 Baths 4 Cars 6.60 ac

Price	SOLD
Property Type	Residential
Property ID	624
Land Area	6.60 ac

Agent Details

Gavin Butler – 0427 887 766

Office Details

Eaglehawk
 42 Goldsmiths Road
 Eaglehawk, VIC, 3556
 Australia
 03 5448 3322



**GAVIN
 BUTLER**
 REAL ESTATE

amenities in Axedale

- Fabulous block just a short walk to the township – power and septic
- A very rare opportunity to secure acreage in this coveted position so close to the central township
- Great opportunity for the investor to develop (STCA) immediately or retain as an investment for the future – the property adjoins an existing residential development

Axedale is a small township on the outskirts of Bendigo, situated in a quite unique rural area with the river flowing through it is the perfect place to raise your family. This beautiful block and home is central but also in a very peaceful and quiet rural area.

This information has been provided to us by third parties and we do not accept any responsibility for its accuracy. You should make your own enquiries and check the information so as to determine whether or not this information is in fact accurate. You must make your own assessment and obtain professional advice if necessary.

The above information provided has been furnished to us by the vendor/s. We have not verified whether or not that information is accurate and do not have any belief in one way or the other in its accuracy. We do not accept any responsibility to any person for its accuracy and do no more than pass it on. All interested parties should make and rely upon their own inquiries in order to determine whether or not this information is in fact accurate.

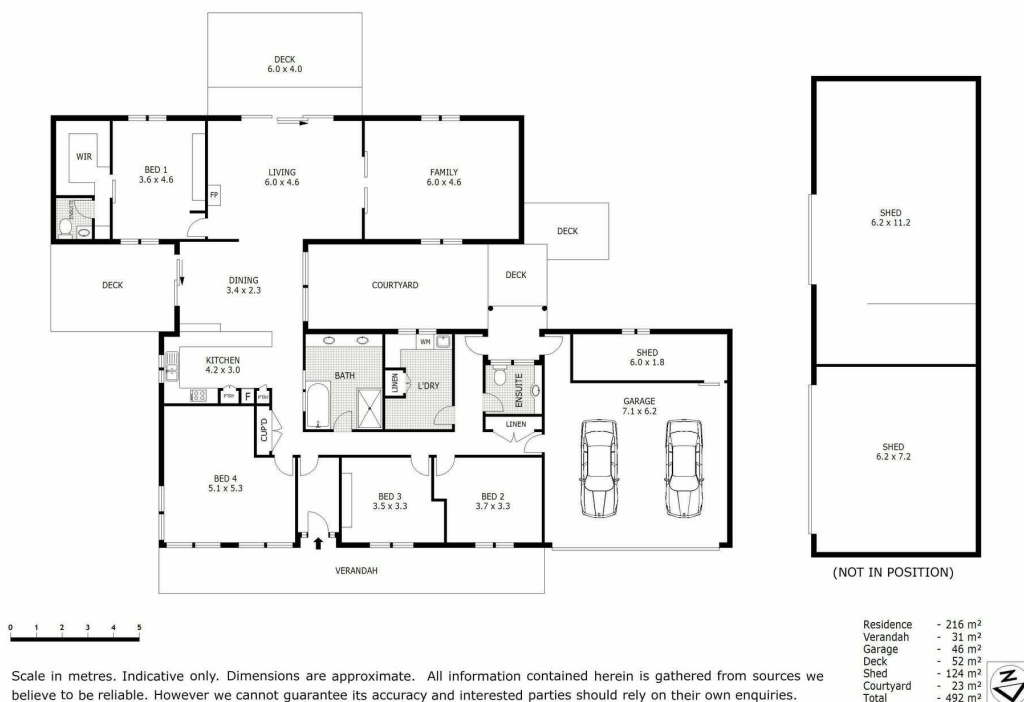

1 Mitchell Street, Axedale